

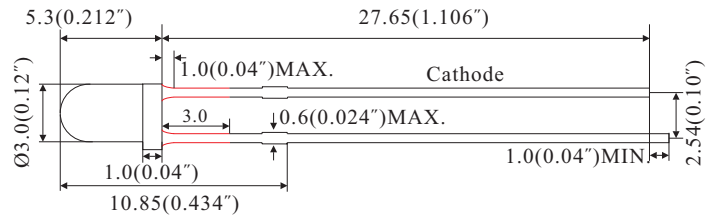

## PACKAGE DIMENSION

**TY-30UY1D60-200**

(OLD P/N: TY-30UY1-14)

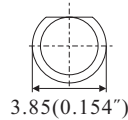

### Selection Guide

Part No.	Dice		Lens Color	(If=20mA)	Viewing Angle
	Raw Material	Emitted Color		TYP. (Mcd)	
TY-30UY1D60-200	AlGaInP	Ultra Bright Yellow	Yellow Diffused	200	60°

### Absolute Maximum Ratings at T<sub>A</sub>=25°C

Parameter	Symbol	Maximum Rating	Units
Power Dissipation	PD	75	mW
Peak Forward Current <sup>4</sup>	IFP	150	mA
Forward Current	IF	30	mA
Reverse Voltage	V <sub>R</sub>	5	V
Capacitance	C	10	pF
Operating/Storage Temperature	T <sub>A</sub> /T <sub>STG</sub>	-40°C to +85°C	
Lead Solder Temperature	T <sub>SOL</sub>	260°C for 3 Seconds	

### Electrical / Optical Characteristics at T<sub>A</sub>=25°C

Parameter	Symbol	TYP.	MAX.	Units	Test Condition
Peak Wavelength	λ <sub>peak</sub>	592	-	nm	I <sub>F</sub> =20mA
Dominant Wavelength	λ <sub>D</sub>	586	-	nm	I <sub>F</sub> =20mA
Spectral Line Half-width	Δλ	20	-	nm	I <sub>F</sub> =20mA
Forward Voltage	V <sub>F</sub>	2.10	2.40	V	I <sub>F</sub> =20mA
Reverse Current	I <sub>R</sub>	-	10	uA	V <sub>R</sub> =5V

Notes:

1. All dimension are in millimeter (inches);
2. Tolerance is ±0.25mm(0.01") unless otherwise specified;
3. Not recommend to solder within 3mm from the resin;
4. 1/10 Duty Cycle, 0.1ms Pulse Width.